



Behind Reliance Petrol Pump, Pal Road, Jodhpur (Raj.)



Created with perfection, Aditya Dwarkadhish Ananta is a blend of modern luxuries and architecture themed around for you to experience a great lifestyle in leisure.

Step into the world of the luxury gated community township that consists of 3 BHK duplex villas for the elite group who wish to live exclusively. It is a gated & Vastu-friendly township for you and your Family to seek a content life with all the top-notch amenities that enhances your. It is positioned in the heart of the city and offers great road connectivity From the most prominent locations of Jodhpur.

Life at Aditya Dwarkadhish Ananta is going to be a dream come true.



## WHY RENT ? when you can own Dream Home



Water Pipeline



Sewerage Line



Damar Roads



Footpath



Park Area



Main Gate Entry



Street Light



Temple Area

“Luxury Gated Community Villas  
3 BHK Duplex Villa Available  
30 Ft. Wide Damar Roads  
Bank Loanable ”



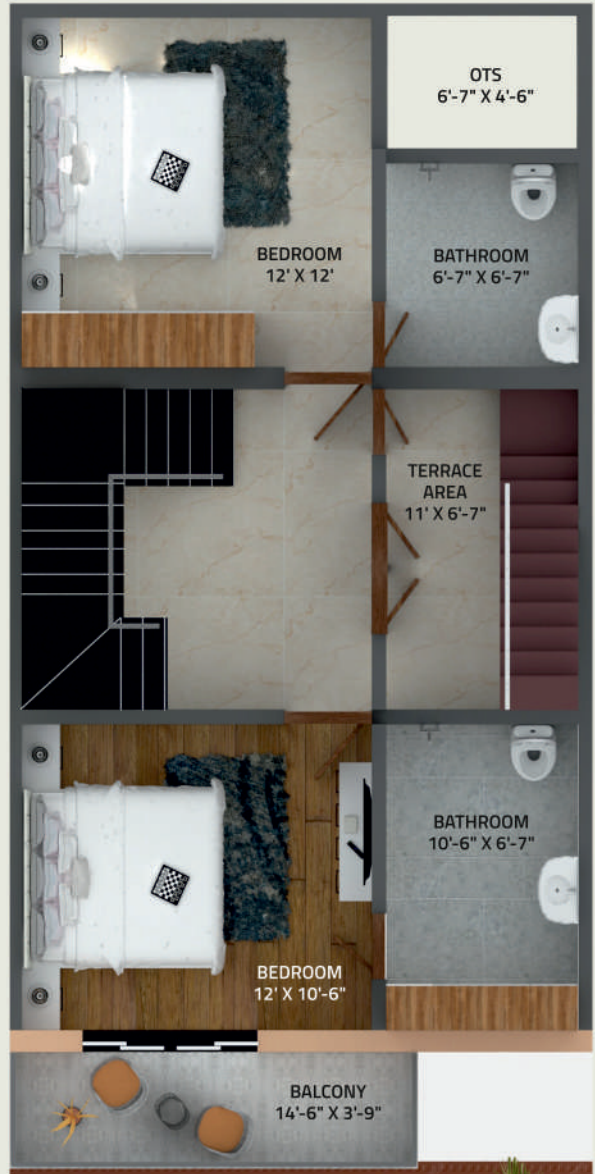

**East Facing Villa : 20' x 40'**

**Built Up Area : 1529 sq. ft.**

**Carpet Area : 1146 sq. ft.**







Surround  
yourself  
with the *good life!*



J.D.A. APPROVED ROAD 40 FT. WIDE

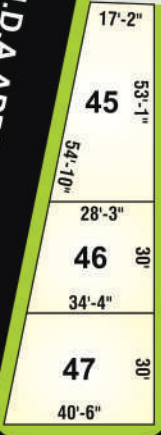

R / W 30'



Park

ROAD 30 FT. WIDE

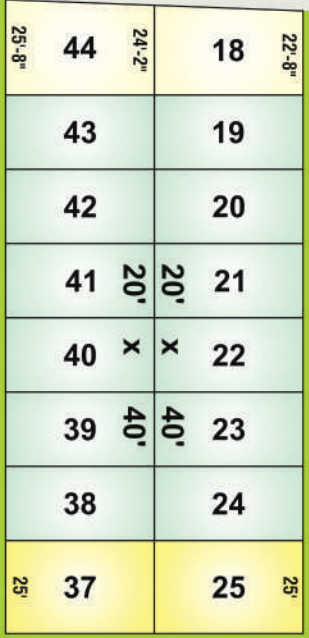

ROAD 30 FT. WIDE

ROAD 30 FT. WIDE



ROAD 30 FT. WIDE



ROAD 30 FT. WIDE

MAIN GATE

EXISTING ROAD





Easy Way To Transport

**Location Advantages :**

- Reliance Pump ..... 1.2 km
- DPS Circle Pal Road ..... 3.6 km
- Jodhpur Railway Station ..... 12 km

Contact : 86967-12345  
 86968-12345  
 0291-2622600

Visit Us : [www.adityabuilders.co.in](http://www.adityabuilders.co.in)



A Project by :  
**ADITYA BUILDERS & DEVELOPERS**  
 1<sup>st</sup> Floor, Amar Tower, Mahendra Motors,  
 Opp. LIC Office, Jaljog Circle, Jodhpur (Raj.)

Site Address :  
**ADITYA DWARKADHISH ANANTA**  
 Behind Reliance Petrol Pump,  
 Pal Road, Jodhpur (Raj.)

Inquiry on WhatsApp.



Please Note : Stamp Duty, Registration Charges, Legal Charges, Municipal Corporation Charges & Electrical - Water connection charges etc. shall be borne by the purchaser. Any additional charges or duties & taxes levied by the government / Local authorities during or after the completion of the project during or after the completion of the project will be borne by the purchaser. Change / alteration of any nature including the elevation, exterior colour scheme of the project or any other changes of the project are strictly not permitted during or after the completion of the project. In the interest of developments in design and quality of construction, the developer reserve all right to make any changes in the project including technical specification and designs. Furniture & fixtures shown in the images of this brochure are just for presentation and are not offered with the project. This brochure is intended only for easy display and information of the project and does not form part of legal document and is open to change / replacement / endoresment on final construction. This brochure is intended only to convey the essential design & technical features of the scheme Academic Institutions in proximity.